

Materials of Construction

| Component | Valve Body Materials | |
|---------------------------|--|--|
| | Stainless steel | Carbon steel |
| | Bonnet Valve | |
| | Grade/ASTM specification | |
| 1. Handle | Stainless steel | Aluminium black anodized |
| 2. Set screw | | SS316/A276 or A479 |
| 3. Packing bolt | SS316/A276 or A479 | C.Steel/A108 |
| 4. Lock nut | | SS316/A276 or A479 |
| 5. Upper gland | | SS316/A276 or A479 |
| 6. Packing | Standard chevron PTFE packing, optional Grafoil | |
| 7. Lower gland | SS316/A276 or A479 | SS316/A276 or A479 |
| 8. Bonnet | | C.Steel/A108 |
| 9. Stem | | SS316/A276 or A479 |
| 10. Non-rotating stem tip | SS630/A564 | |
| 11. Lock plate bolt | Stainless steel | |
| 12. Spring washer | Stainless steel | |
| 13. Lock plate | Stainless steel | Carbon steel |
| 14. Body | SS316/A276 or A479 | C.Steel/A108 or A105, Yellow zinc galvanized |
| Flange seals (not shown) | PTFE/D1710, optional Grafoil and fluorocarbon FKM O-ring | |
| Flange bolts (not shown) | Stainless steel/A193 | Carbon steel/A193 |
| Lubricant | Fluorinated base with PTFE and tungsten disulfide Hydrocarbon based | |

Wetted components are listed in blue.

Grafoil: TM UCAR

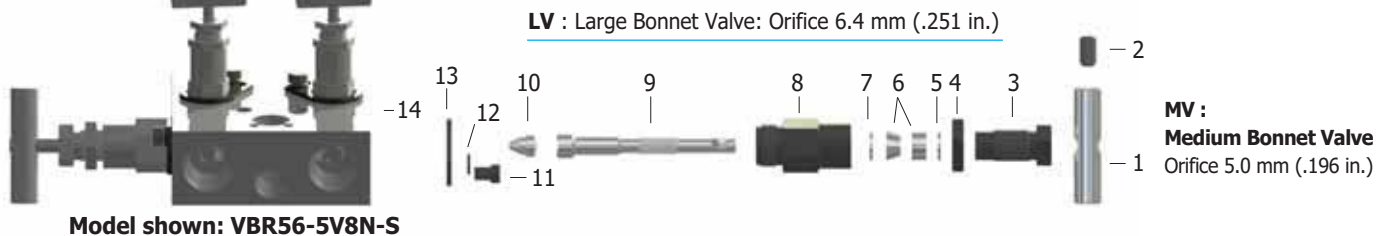

Features

- **Non-rotating** stem tip at closure for long-life and leak-tight shutoff.
- **Chevron PTFE packing** design provides far improved sealing integrity.
- **Packing** below stem threads is to isolate **threads** from system fluid and lubricant washout.
- Packing bolt permits stem **packing adjustment**.
- Standard **Lock plate** ensures the valve fastened to the body even excessive operating torque is applied.
- **One piece body construction** provides strength.
- Burr-free internal surface.



Image shown:
Bonnet Valve.

Feature of packing below stem thread maintains in small, medium and large bonnet valve on manifolds as well as on gauge root valves.



VES56 series **slotted flange** feature facilitates manifolds mounting with long stud hex nut.

Model shown: VES56-5V1F8N-C

Pressure-Temperature Ratings

Manifolds and Gauge Root Valves

| Body Material | Packing material | Temperature Rating | Pressure Rating @ 37 °C (100 °F) | Pressure Rating @ Max. Temp. |
|-----------------|------------------|------------------------------------|----------------------------------|--|
| Stainless steel | PTFE | - 54 to 232 °C (-65 to 450 °F) | 413 bar (6000 psig) | 285 bar@232 °C 4130 psig@450 °F |
| | Grafoil | -54 to 648 °C (1) (-65 to 1200 °F) | | 118 bar@648 °C 1715 psig @ 1200 °F |
| Carbon steel | PTFE | - 29 to 176 °C (-20 to 350 °F) | 413 bar (6000 psig) | 360 bar @ 176 °C (5230 psig @ 350 °F) |
| | Grafoil | - 29 to 176 °C (-20 to 350 °F) | | |

(1) Grafoil packing rating is limited to 537 °C (1000 °F) with flange end connection. In air, Grafoil rating is limited to 523 °C (975 °F), in steam it can go up to the maximum temperature of 648 °C (1200 °F).

- -28 to 204 °C (-18 to 399 °F) with optional fluorocarbon FKM flange seals.



Design

- D-Pro Manifolds and Gauge root valves are designed to ASME B16.34 Class 2500 for pressure-temperature ratings.
- Pressure boundary wetted parts are selected to Chapter III, 123 Materials of ASME B31.1.
- Valve ratings are based on ASME process piping code B31.3.
- To determine pressure rating at 37 °C (100 °F) in accordance with Power piping code B31.1, multiply by 0.94 for stainless steel.

Factory test

- Every manifolds and gauge root valve is factory tested with nitrogen @ 69 bar (1000 psig) for leakage at the seat to a maximum allowable leak rate of 0.1 SCCM.
- Stem packing is tested for no detectable leakage.
- Optional hydrostatic shell test is performed with pure water at 1.5 times the working pressure.

Packing adjustment and Actuation Torque

- Extreme or rapid temperature cycle while valve in service may require packing adjustment. Tighten the packing bolt 1/16 turn clockwise.
- Valves that have not been actuated for a period of time may have a higher initial actuation torque.

Sour Gas Service

- For use valve in sour gas, materials for wetted components are selected in accordance with NACE MR0175 latest revision.

Ordering and Technical Information

| Manifolds | Basic Ordering Number | End Connections | | Orifice mm (in.) | Weight Kg (lb.) |
|--------------|-----------------------|---|------------|------------------|-----------------|
| | | Process | Instrument | | |
| Remote Mount | VBR56-2V8N- | 1/2 in. Female NPT | | 3.2 (.126) | 0.8 (1.8) |
| | VBR56-3V8N- | | | 6.4 (.251) | 2.0 (4.4) |
| | VBR56-5V8N- | | | | 2.2 (4.9) |
| Direct Mount | VE56-2V1F8N- | 1/2 in. Female NPT to Flange. Flange design meets MSS SP-99. | | 3.2 (.126) | 1.0 (2.2) |
| | VE56-3V1F8N- | | | 6.4 (.251) | 2.2 (4.9) |
| | VE56-5V1F8N- | | | | 2.7 (6.0) |
| | VE56-3V2F- | Flange to Flange. Flange design meets MSS SP-99 | | 6.4 (.251) | 2.5 (5.5) |
| | VE56-5V2F- | | | | 2.7 (6.0) |
| | VES56-2V1F8N- | 1/2 in. Female NPT to Flange. Flange design meets MSS SP-99. | | 3.2 (.126) | 1.0 (2.2) |
| | VES56-3V1F8N- | | | 6.4 (.251) | 2.2 (4.9) |
| | VES56-5V1F8N- | | | | 2.7 (6.0) |
| | VES56-3V2F- | Flange to Flange. Flange design meets MSS SP-99 | | 6.4 (.251) | 2.5 (5.5) |
| | VES56-5V2F- | | | | 2.7 (6.0) |
| | VBD56-2V8N- | 1/2 in. Female NPT to Flange. Flange design meets MSS SP-99. | | 3.2 (.126) | 1.6 (3.5) |
| | VBD56-3V8N- | | | 5.0 (.196) | 1.7 (3.8) |
| | VBD56-5V8N- | | | 6.4 (.251) | 3.3 (7.3) |
| | VBD56S-5V8N- | | | 5.0 (.196) | 2.7 (6.0) |

How to order manifolds with options

- To order the optional Grafoil packing, add -GF to the ordering number. i.e., VES56-3V1F8N-GF-
- To order sour gas service valve, add-SG to the ordering number. i.e., VES56-3V1F8N-GF-SG-
- To order optional GRAFOIL or FKM O-ring flange seal, add -GF or -VT to the ordering number/ i.e., VES56-3V1F8N-GF-SG-GF(or- VT)-
Flange seal designators: -GF for Grafoil, - VT for FKM O-ring.
- To complete the ordering number, select valve body material designator:
- S for SS316, - C for Carbon steel. i.e., VES56-3V1F8N-GF-SG-VT-S.

Remote mount

Unit: mm (in.)

VBR56-2V8N-

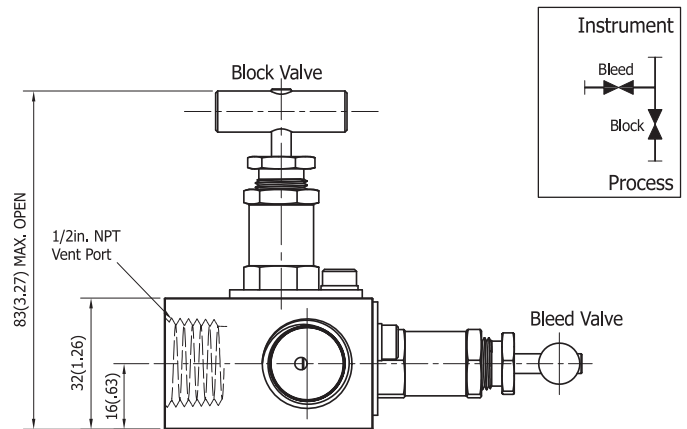
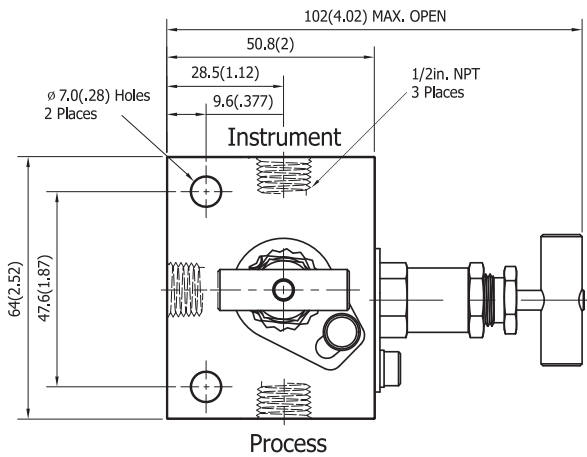

VBR56-3V8N-

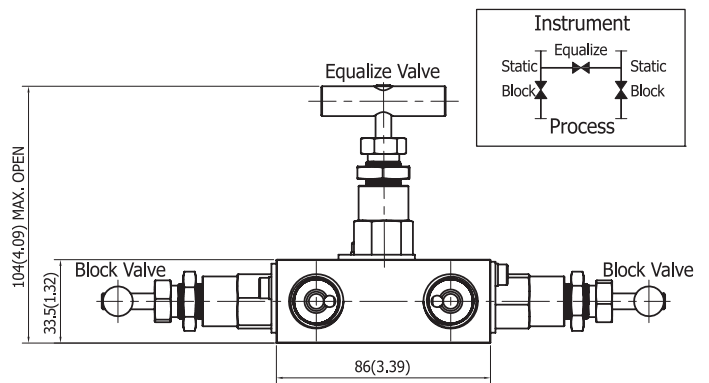
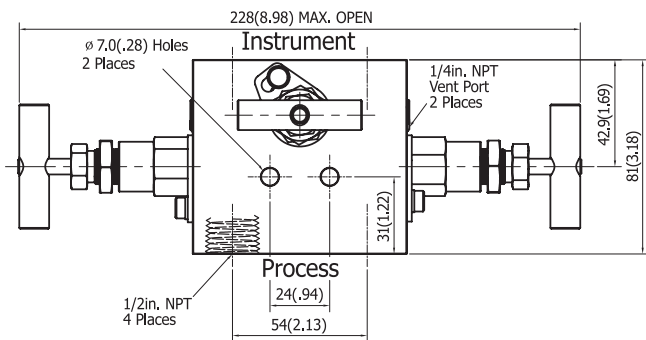

VBR56-5V8N-

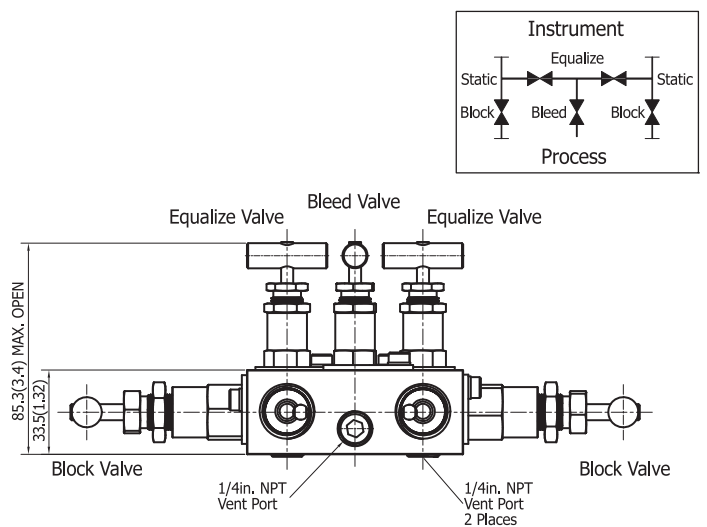
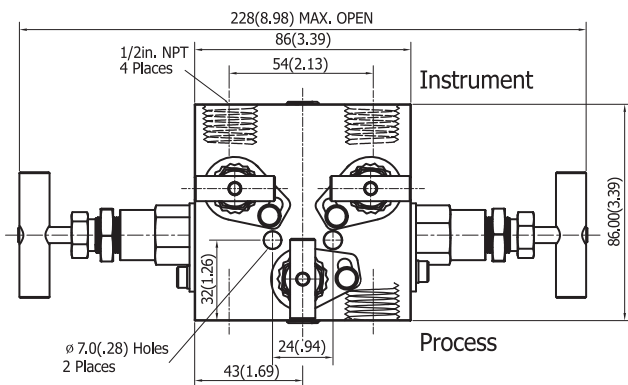

Single Flange Direct Mount

Unit: mm (in.)

VE56-2V1F8N- / VES56-2V1F8N-

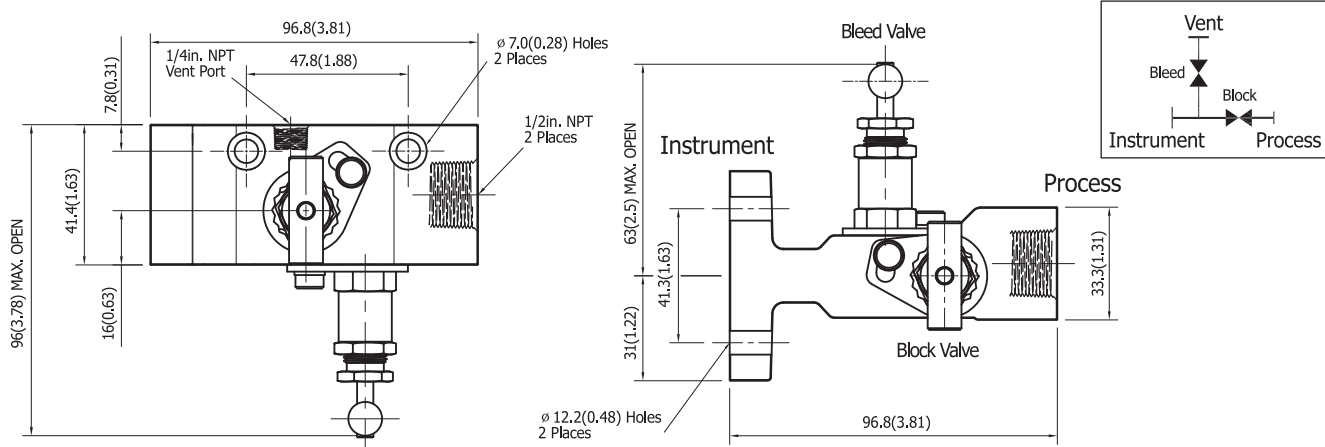

VE56-3V1F8N- / VES56-3V1F8N-

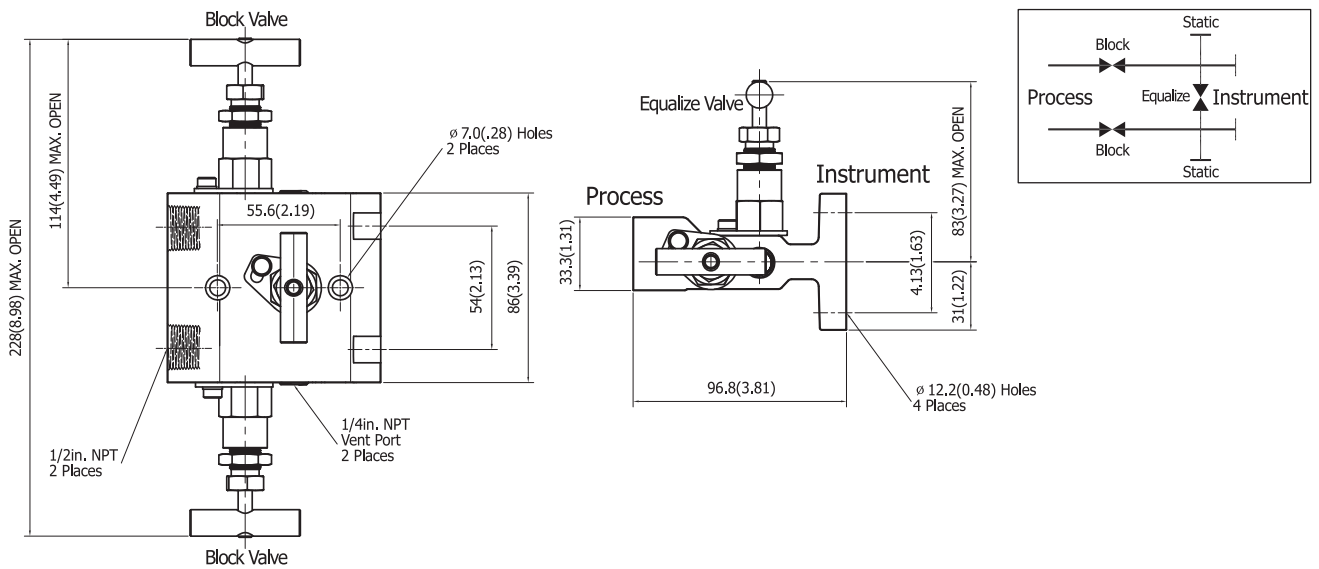

VE56-5V1F8N- / VES56-5V1F8N-

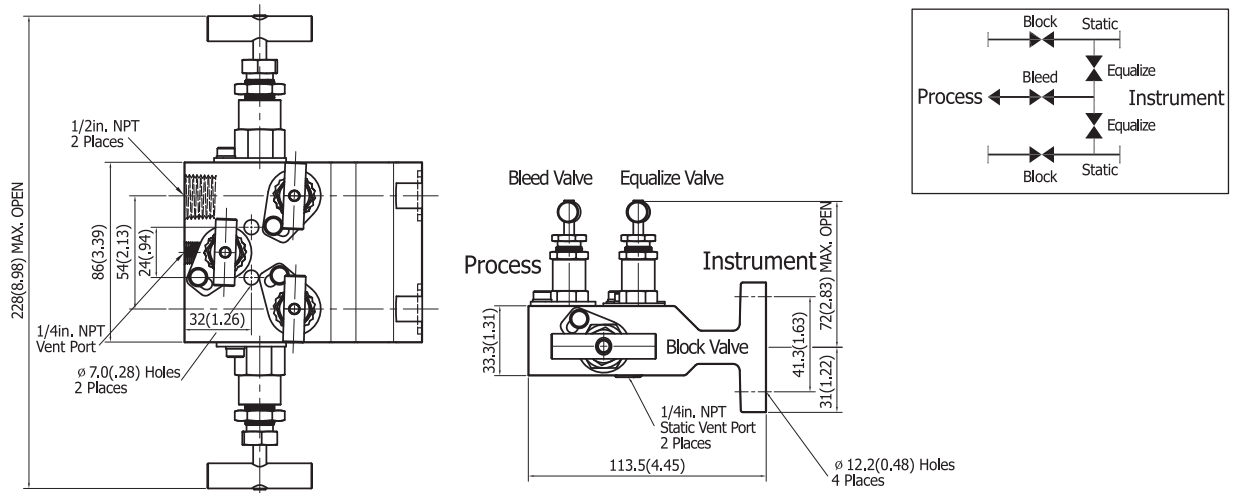

Double Flange Direct Mount

Unit: mm (in.)

VE56-3V2F- / VES56-3V2F-

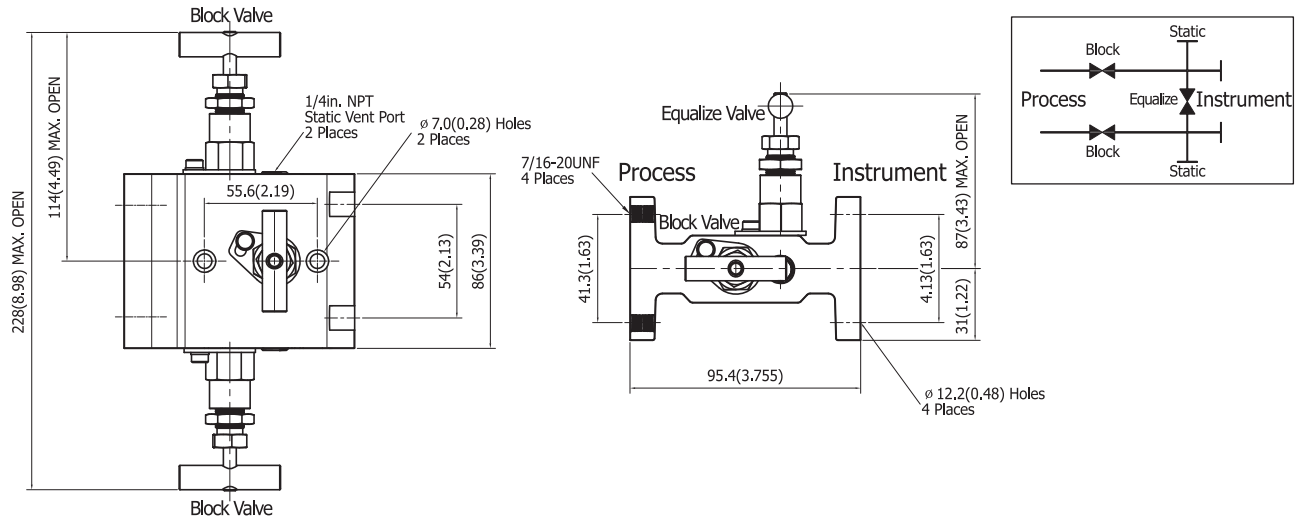

VE56-5V2F- / VES56-5V2F-

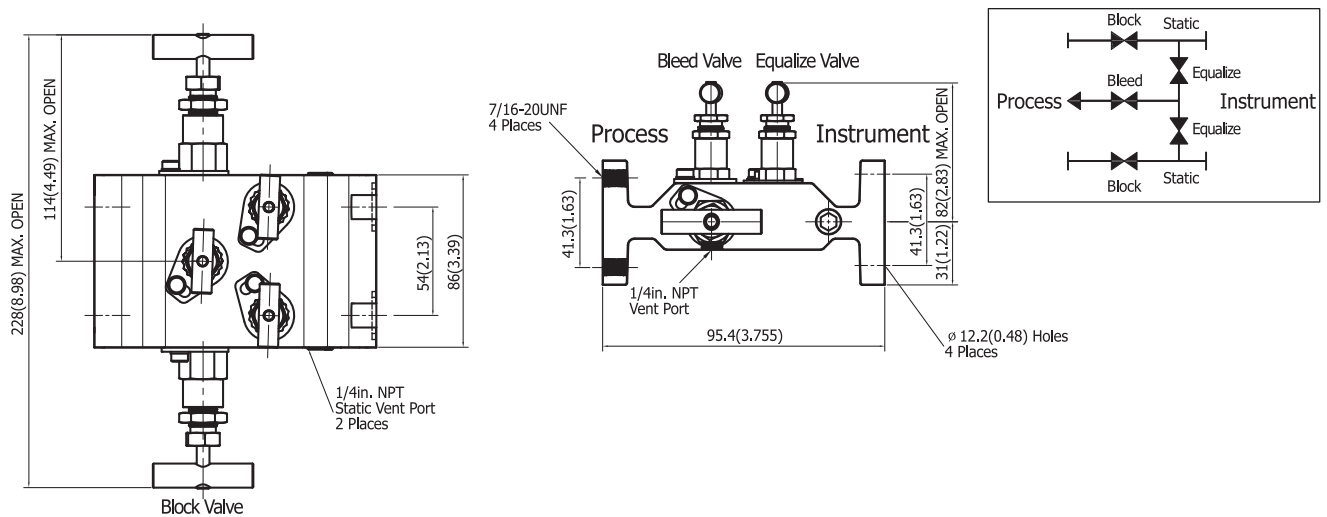

Vertical Direct Mount

Unit: mm (in.)

VBD56-2V8N-

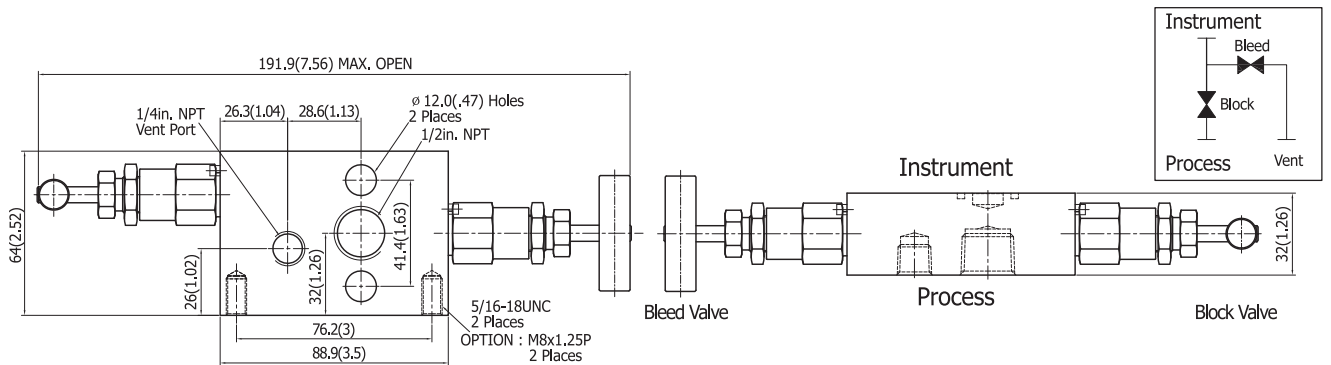

Vertical Direct Mount

Unit: mm (in.)

VBD56-3V8N-

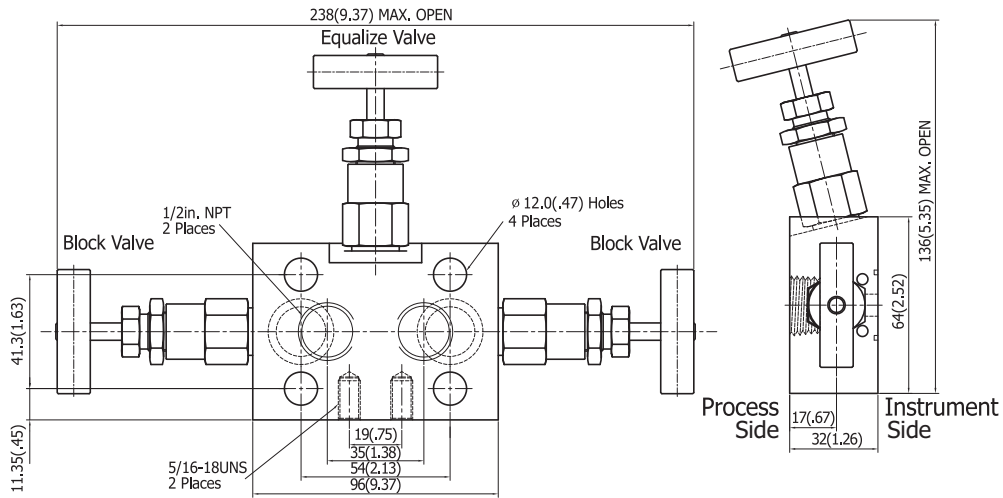

VBD56-5V8N-

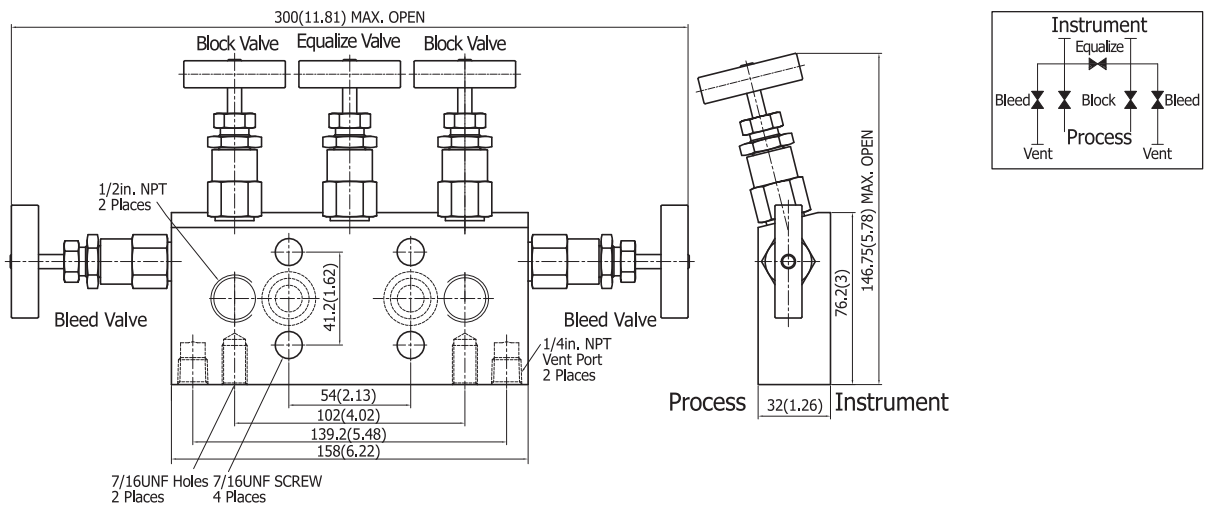

VBD56S-5V8N-

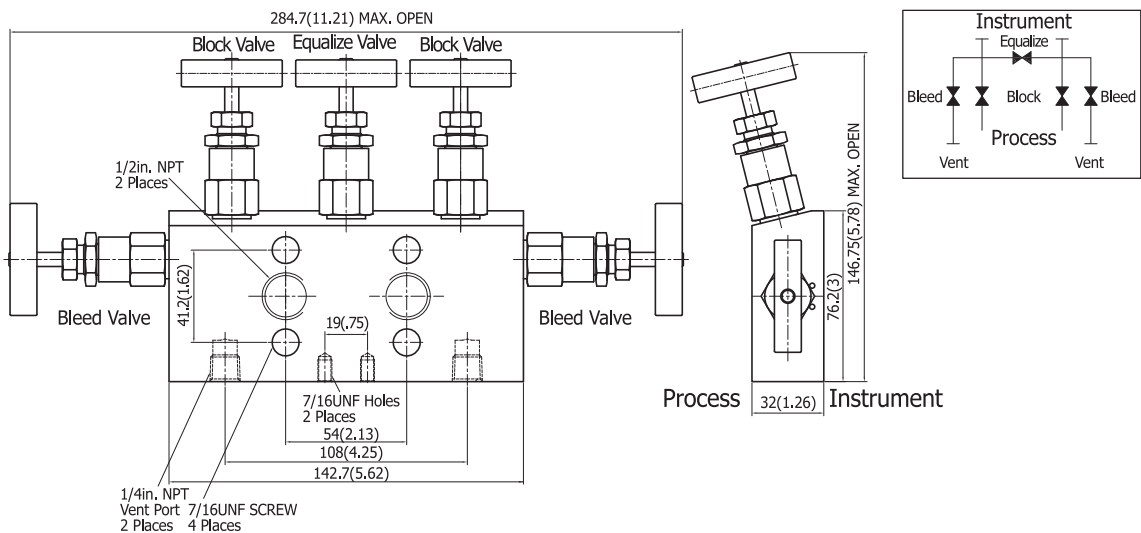

Manifolds Accessories

Flange Bolts

For special mounting applications optional long and short bolts are available. See flange bolt specification below.

| Flange Bolt | Threads | Length mm (in.) | Hex Size mm (in.) | Basic Ordering Number | Bolt Material Designator |
|---------------------|---------|--------------------|----------------------|--------------------------|---------------------------------------|
| Standard hex bolt | 7/16-20 | 45.0 (1.77) | 15.87 (5/8) | Z56BM- | Stainless steel: S Carbon steel: C |
| Long stud hex nut | 7/16-20 | 58.0 (2.28) | | Z56BL- | |
| Short hex head bolt | 7/16-20 | 25.0 (.98) | | Z56BS- | |

To order, add the material designator to the bolt ordering number. i.e., Z56BM-S

- Slotted flange manifolds is supplied with long stud hex nut: Z56BL-

Flange Seals

Flange seals are available in standard PTFE, Grafoil and fluorocarbon FKM O-ring for system compatibility.

| Seal Material | Temperature Rating °C (°F) | Ordering Number |
|--------------------------|----------------------------|-----------------|
| PTFE | -53 to 121 (-65 to 250) | Z56PE |
| Grafoil | -53 to 537 (-65 to 1000) | Z56GF |
| Fluorocarbon FKM (Viton) | -28 to 204 (-18 to 399) | Z56VT |

To order, use the ordering number. i.e., Z56PE.

Oval Flange & Pipe Nipple

Eccentric Flanges and Pipe Nipple allow connections of flange-to-flange manifolds to process flange taps or process root valves.



Oval Flange Ordering Number and Technical Information

| Material | End Connection | End Connection Size | Ordering Number |
|-----------------|----------------|------------------------|--------------------|
| Stainless steel | Female NPT | 1/2 in. NPT | V56OF-8N-S |
| Carbon steel | | | V56OF-8N-C |

Pipe Nipple Ordering Number and Technical Information

| Material | Ordering Number | Type | Pressure Rating @20°C(70°F)bar(psig) | Temperature Rating°C(°F) | Pressure Rating @ Max. Temp. |
|--------------------------|--------------------|------------|---|-----------------------------|---|
| Stainless steel /A276 | G56NE-8N-S | Eccentric | 516 (7 500) | -53 to 648 (-65 to 1200) | 147 bar @648 °C (2140 psig @1200 °F) |
| | G56NC-8N-S | Concentric | 689 (10 000) | | 196 bar @648 °C (2850 psig @1200 °F) |

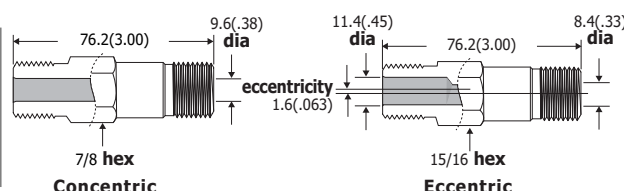

Calibration Fittings

Select DK-LOK differential pressure calibration fitting depending on the bleed port of the transmitter plug.

Ordering Number

| Material | Ordering Number | DK-LOK OD | Straight Male Thread |
|--------------------------|--------------------|-----------|----------------------|
| Stainless steel /A276 | DPCM4-1U-S | 1/4 in. | 1/4-28UNF |
| | DPCM4-2U-S | | 5/16-24UNF |



Mounting Bracket Kit

Bracket kit containing bracket, U-bolt, bolt, nut and washer allows horizontal and vertical manifold mounting.

| Material | Ordering number |
|-----------------|-----------------|
| Stainless steel | Z56MBK-S |
| Carbon steel | Z56MBK-C |



Manifold Mounting



Bonnet Valve Kit

Bonnet valves are available for field assembly.

| Bonnet Valve | Basic Ordering Number | Packing Material Designator | Bonnet Valve Material Designator |
|---------------------|--------------------------|--------------------------------|---------------------------------------|
| Small Bonnet Valve | V56SV- | PTFE: Nil Grafoil: GF | Stainless steel: S Carbon steel: C |
| Medium Bonnet Valve | V56MV- | | |
| Large Bonnet Valve | V56LV- | | |

- Kit contains bonnet valve, lock plate and set screw.

How to order

Select designator for the desired packing and valve material.
i.e., V56SV-GF-S

D-Pro V46 series Gauge Root Valves

D-Pro Gauge Root Valves offer a safe way of positioning gauges and installing pressure switches.

Features

- 1/2 in. and 3/4 in. male to 1/2 in. female end connections.
- 1/2 in. female gauge ports standard.
- Minimum schedule 160 pipe wall on valve inlet.

Ordering Information and Technical Data

| Valve Ordering Number | End Connection Male to Female NPT | Orifice mm (in.) | Body Length mm (in.) L | MAX. OPEN H | SQ | G | A |
|-----------------------|--------------------------------------|---------------------|------------------------------|----------------|----------|-------------|-------------|
| V46G-8N-S | 1/2 to 1/2 in. | 5.0 (.20) | 90.0 (3.54) | 85.9(3.38) | 32(1.26) | 38.10(1.50) | 50.00(1.97) |
| V46GR-8N-S | 1/2 to 1/2 in. | | 136.0 (5.35) | | | | |
| V46GR-12N8N-S | 3/4 to 1/2 in. | | 136.0 (5.35) | | | | |
| V46GRL-8N-S | 1/2 to 1/2 in. | | 184.0 (7.24) | | | | |
| V46GRL-12N8N-S | 3/4 to 1/2 in. | | 184.0 (7.24) | | | | |
| V46V2-8N-S | 1/2 to 1/2 in. | | 127.0 (5.00) | | | | |

- V46GRL has an extended 4.8 inch of pipe insulation.
- V46 series uses Medium Bonnet Valve: Orifice 5.0 mm (.196in.)

How to order

- To order Grafoil option, insert -GF in the ordering number. i.e., V46G-8N-**GF**-S
- To order sour gas service valve, insert -SG in the ordering number. i.e., V46G-8N-**GF-SG**-S

Unit: mm (in.)

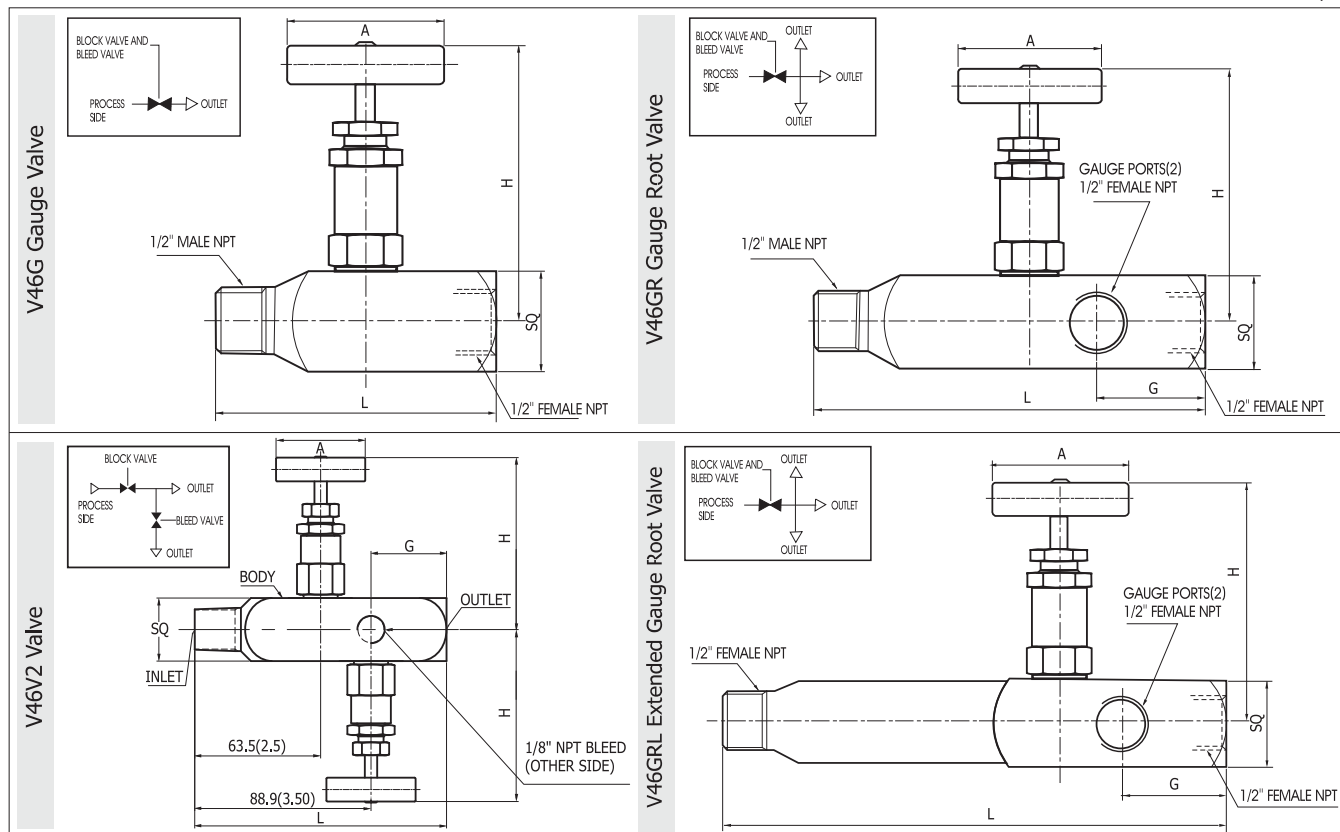

Double Purge-Blowback Manifold and Single Purge-Blowback Manifold

Double Purge-Blowback Manifold
DKM7-TV-AF1F2-#2(#6)-S
Connected with DKM-GU3M-T-S-AF1

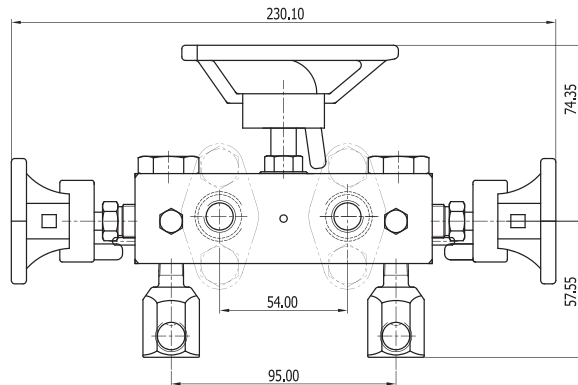

Single Purge-Blowback Manifold
DKM6-TV-F2F2-#2(#6)-S

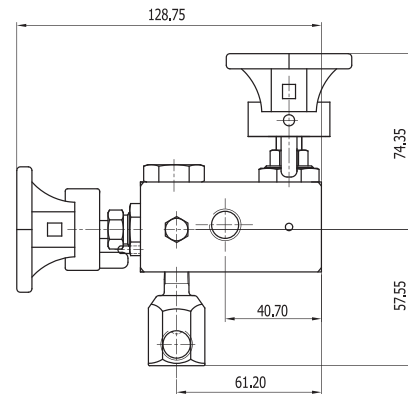

Pressure Rating with Teflon seat: 2,500psig @100°F (38°C)
All wetted & exposed parts are ASTM A276/A479 type 316
TV: Teflon seat with Viton o-ring seal is Standard
TK: Teflon seat with Kalrez o-ring seal is Optional
Capillary Plug #2: 3.2SCFH Air@10 psig
Capillary Plug #6: 0.40SCFH Air@10 psig
Gauge Port: 1/8" MNPT to 1/4" FNPT

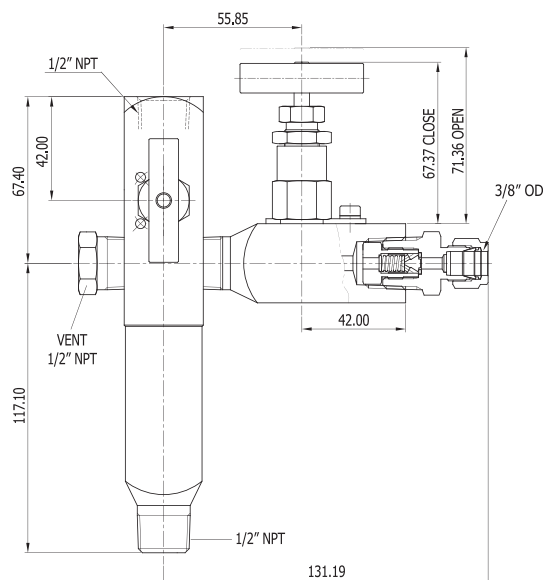
D-Pro[®] Gauge Root Valves**V46 Series****Chemical Injection Kit****Chemical Injection Kit: CIK-8N-SA**

- Pressure Rating: 6,000psig@100°F (38°C)
- Body & Bonnet Material: ASTM A276/A479 type 316
- Stem Material: ASTM A276/A479 type 316
- Stem: Non-rotating
- Stem Packing: PTFE
- Spring Material: SS302
- Nominal Cracking Pressure: 5 psig

Safe Valve Selection

The selection of a valve for any application or system design must be considered to ensure safe performance. Valve function, valve rating, material compatibility, proper installation, operation and maintenance remain the sole responsibility of the system designer and the user. Dk Tech accepts no liability for any improper selection, installation, operation or maintenance.

DK-LOK[®] USA

■ 3350 SpringHill Ave., Mobile, AL 36607 ■ T: (251) 472-9580 ■ F: (251) 450-0962 ■ Toll Free: (800) 328-5803

www.dklokusa.com